



# SPARKLE

## Stylish and cosy

Are you looking for stylish accommodation for couples? Sparkle is the answer. A compact glamping tent where your guests can relax on the wooden veranda with a drink in hand and enjoy a good night's sleep after spending the day in the great outdoors.

The Sparkle is perfect for a romantic break, but it also makes an excellent choice for cyclists and hikers, who need a practical, yet comfortable, base.

It is sturdy, with a wooden frame and it has an ideal standing height. To save you time, the Sparkle needs little maintenance and can stay outside during the winter months. If you need extra accommodation for large groups, this model can be used in combination with one of our other bigger lodges, such as the Sunrise.

- ✓ Surprisingly stylish at a low entry-level price for optimal ROI
- ✓ Practical, yet comfortable, with room to stand up
- ✓ Perfect as an add-on to other lodges
- ✓ Ready to move in, so you can host guests immediately

# FLOORPLAN SPARKLE 7.5

## Dimensions

Inner tent	7.5 m <sup>2</sup>	2.5 x 3 m
Veranda	3.1 m <sup>2</sup>	2.5 x 1.25 m
Total surface	10.6 m <sup>2</sup>	2.5 x 4.25 m
Footprint	20.3 m <sup>2</sup>	3.9 x 5.2 m

## Features

# Guests	2
# Bedrooms	1
Bathroom	No
Kitchen	No

## Floorplan 2D

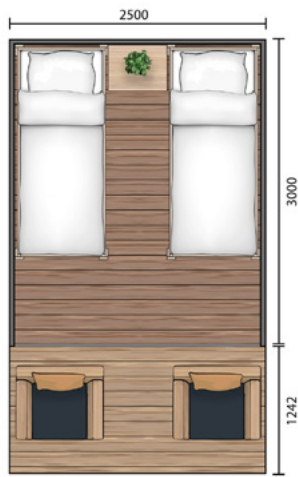

# FLOORPLAN SPARKLE 12

## Dimensions

Inner tent	12.4 m <sup>2</sup>	3.1 x 4 m
Veranda	3.9 m <sup>2</sup>	3.1 x 1.25 m
Total surface	16.3 m <sup>2</sup>	3.1 x 5.25 m
Footprint	29.1 m <sup>2</sup>	4.7 x 6.2 m

## Features

# Guests	2
# Bedrooms	1
Bathroom	No
Kitchen	No

## Floorplan 2D

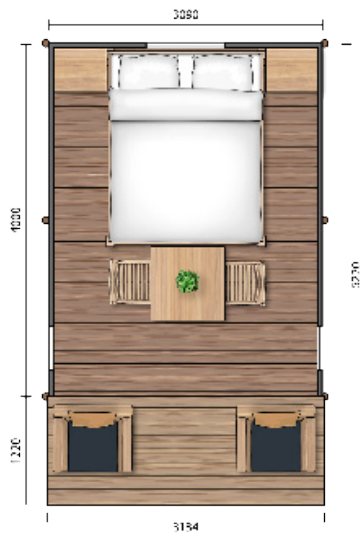

# PHOTOS SPARKLE



# SPECIFICATIONS SPARKLE

Elements	Colour	Specifications	Technical standards
PVC Roof	Beige Brown Green	UV and flame retardant PVC 650gr/m <sup>2</sup> .  The PVC is easy to clean and meets the stringent European, British and American fire regulations (M2, B2 and DIN 4102 standard).	BS 7837  DIN 4102 – Class B2  M2 Classification NFP 92-503  EN 13501-1 B-s3, d0  Total weight DIN and ISO 2286-2 – 650 gr/m <sup>2</sup>
Flame retardant Polyester (FPTC420)	Khaki	Flame retardant 420 gr/m <sup>2</sup> . The fibers in this fabric provide extra security and protection. It is scorch, glow and spark resistant. Textile material that is flame retardant has an inhibiting effect on the occurrence of fire and slow fire spreading.	Weight 420gr/m <sup>2</sup> + 5%  Standarder width: 150 cm  Tearing strenght: ±10%  - Warp: 76N  - Weft: 53N  Tensile strength: ± 10%  - Warp: 2800N/5 cm  - Weft: 2232N/5 cm  Watercolumn: ≥ 400mm  Color fading level: GR6   ISO105B04-1994  Mildewtreated: Level 0   AATCC30-2017  Fireproof level: M2   BS7837-1996
PolyCotton	Beige	PolyCotton consists of a perfect blend of 70/30 polyester and cotton. The fibre mixed in the yarn provides a very even performance. The breathable and moisture regulation properties of cotton are complemented by the extra strength and durability of polyester for intensive use, without sacrificing a natural feel.	70% Polyester, 30% cotton  Width: 150 cm  Weight 430 gr/m <sup>2</sup>  Tensile strength Warp 2100N Weft 1400N  Tearing strength Warp 60N  Weft 50N  Watercolumn 50 cm  Colour fading level: GR6   ISO105B04-1994  Mildew treated: Level 0   AATCC30-2017
Fixing		The inner tent hanging system is a unique system. It has no point loading, so the weight is equally distributed across the surface of the structure.	
Construction		The connectors of the construction are made from 3 mm hot dipped galvanized steel.  The poles have a diameter of 80 or 100 mm.	

## Why choose us?

It's all in the detail. Our beautiful, sustainable glamping tents are not mass produced, but are created by a team of specialists with a passion for outdoor living. We personally manage every aspect, from the initial concept and product design, to the sourcing of eco-friendly materials and construction, to quality control. And it doesn't stop there, we provide ongoing service and support, long after you bought your tent or lodge.

## Interested?

Get in touch to find out more about our tents, or come and see them for yourself. Email us on [sales@yalacanvaslodges.com](mailto:sales@yalacanvaslodges.com) and we'll get right back to you or call us on +31 (0) 527 620 325.

## More info about the materials

[Video about Polycotton Ka46](#)

